

### Projection mode setup

System setup > projection setup > projection mode setup, choose projection mode according to device placed condition.

### Stepless zooming

System setup > projection setup > Stepless zooming, to adjust frame size and aspect ratio.

### Image adjustment

Long press "menu (≡)" key for 2 seconds, release "menu" key, shortcut setting function will popup on the bottom of screen, adjust image according to your preference.

### Keyboard setting

System setup > general > keyboard, choose input method.

### Device name

System setup > about > device name, to choose or customize your device's name.

## 8 Power Bank

### 1. Turn on / off power bank

- Keep press "on/off" button of power bank for 2 seconds to turn on / off charging function.
- When charging function is on, red LED light flashes continuously. When charging function is off or power is 0%, red LED light extinguishes.

### 2. Checking battery status

- Press "on/off" button, if battery power > 50%, LED light is green; if battery power < 50%, LED light is red; if battery power is 0%, LED light extinguishes;

Note: this device only accepts the original power adapter charging, it doesn't support USB charging.

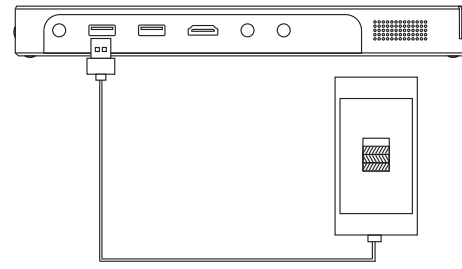

## 9 System update

### 1. Online update:

- System setup > About > System update, device will send update notification when system detected current version is not the latest version, press "online update" to update online.

### 2. USB update:

- Go to XGIMI official website to download USB force update patch, decompress the file and send to USB.
- Connect the device to power supply, then plug USB in USB 2.0 port of the device.
- System setup > about > system update > USB update, wait for force update complete.
- Or press and hold power bank button, simultaneously open the lens cap.
- Wait until the system enters update interface, loosen the button and wait for update complete.

Note: please do not remove USB or power supply during updating process, please use FAT32 form USB.

## 10 Video playing setup

### • Play progress adjustment

Use "left" and "right" keys to adjust play progress.

### • Subtitle setup

When playing a video, press "menu (≡)" key to choose subtitle menu to set subtitle.

### • 3D setup

When playing a video, press "menu (≡)" key to choose 3D setup menu and set 3D mode.

## 11 Device connection & mirroring display

### • Network setup

System setup > network setup > WiFi setup, choose a network and connect with it.

### • WiFi hotspot

System setup > network setup > WiFi hotspot, turn on WiFi hotspot to let other devices find this WiFi hotspot in their WiFi setting, enter password of this hotspot and connect to XGIMI device.

### • Miracast

System setup > network setup > Miracast, turn on Miracast, handphone or PC that support Miracast can connect XGIMI and use it as mirroring display.

### • AirPlay

System setup > network setup > AirPlay, turn on AirPlay, mobilephone or PC that support AirPlay can connect XGIMI and use it as mirroring display.

### • Bluetooth & external device

System setup > Bluetooth & external device, pair and connect with external blue tooth devices, e.g. speaker, remote-control, and gamepad.

### • Wired setup

System setup > network setup > wired setup, plug internet cable into the internet port which is at the back of XGIMI.

## 12 Resource management

### 1. Add device

FileManager> add device, choose the device to be added and add remote sharing file.

### 2. File management

FileManager> long press "OK" key, selection box appears. Press "menu (≡)" key to choose copy/ cut/ paste/delete/ rename/ detail.

### 3. File viewing

Plug in USB, press "FileManager", view the files of USB device, press "menu (≡)" key to open more functions.

### 4. Magic popup

Stay on home page, press "up" key to open shortcut entry at the top of screen, functions from left to right are switching of desktop versions/ WiFi setup/ Bluetooth/ eject USB.

Stay on home page, press "down" key to open collection entry at the bottom of screen, users are able to add favorite Apps in collection entry and quickly open the Apps.

Stay on home page, press "left" key until the end to open input shortcut entry at the left side of screen, and choose preferred input source.

## 13 XGIMI Assistance

Scan the QR code to download XGIMI assistant

- mobile phone remote: device can be easily controlled by mobile phone

mobile phone resource: send the resource from mobile phone to device to view photos or videos

mirroring display control: mirroring to hand phone, support gravity sensor games.



## Product specification

Product specification			
Optical parameters	Product classification	Home Projector	
	Display technique	0.3" DMD RGB-LED	
	Lens	High light transmission coated lens	
	Specialty	3D	
	Luminance	250ANSI lumen	
	Luminance uniformity	98%	
	Color gamut	>=120%NTSC	
	Contrast	5000:1	
	Standard resolution	WXGA(1280x720)	
	Compatible resolution	1080P/2K	
Projection parameters	Projection ratio	1.2:1(76-inch@2M)	
	Keystone correction	Vertical: ±40 degree	
System parameters	Projection method	Forward/backward/ hang ceiling	
	GPU	Quad-core 1GHz	
	GPU	Mali-450MP2	
	RAM	1GB DDR3	
	Storage	16GB eMMC	
	System	Android 4.4	
	Mirroring display	Airplay/DLNA/Miracast	
	Ports	Input ports	HDMI x1 USB2.0 x1 USB3.0 x1
		Output port	Headphone/SPDIF x1
		WiFi	Dual-band 2.4/5GHz, 802.11a/b/g/n/acc 2x2 dual antennas
Bluetooth		Bluetooth 4.0 BLE	

Electrical parameters		
Other parameters	Noise	<30dB
	Power dissipation	Battery mode: 17-27W, with power supply: 39-45W
	Power	AC100-240V, 50/60Hz
	Battery	13600mAh
Packing list	Size	113.5 x 214 x 23.5mm
	Weight	0.65kg
	Powerplug	x1
	Bluetooth remote-control	x1
Remote-control charge cable	x1	
Handbook	x1	
HDMI cable	x1	



This device complies with part 15 of the FCC Rules. Operation is subject to the following two conditions:  
1. This device may not cause harmful interference.  
2. This device must accept any interference received, including interference that may cause undesired operation.

# Z4Air

XGIMI™

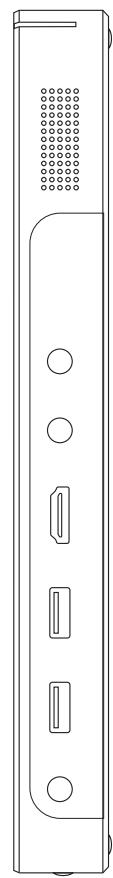

On/off

Voice key

HDMI

USB 3.0

USB 2.0

charging interface

## 1 Get Started/Shutting down

- Plug into electric power supply.
- Open the lens cover, the device is turned on.
- Close the lens cover, the device is turned off.

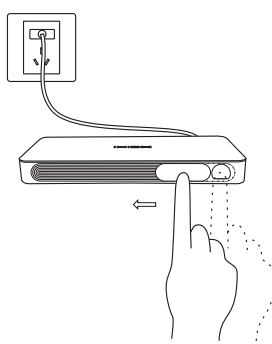

## 2 Focusing

- Toggle the focusing wheel, adjust the image definition.

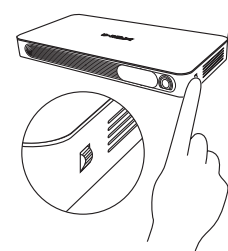

## 3 Bluetooth Remote-control

### 1. Keys description

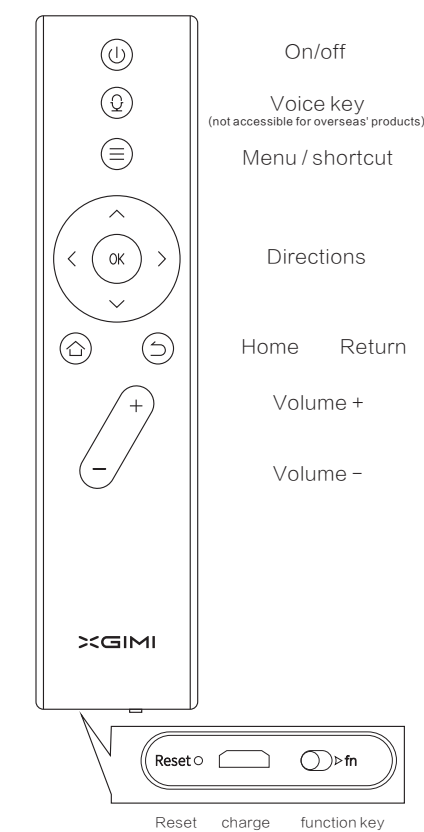

### 2. Remote-control pairing

Note: Please charge the remote-control for 30 minutes before the first time use.

- Please put the remote-control within 10 cm from the device.
- Press "return" and "home" at the same time, green indicator light change to blue. After the blue indicator light quickly blinks, release the buttons, remote control is pairing. If pairing is successful, blue indicator light flashes continuously for 2 seconds and then extinguishes. If pairing is failed, exit pairing mode after 30-seconds timeout, follow the steps above to pair again.

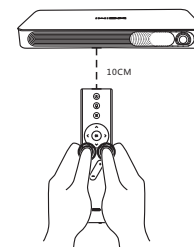

### 3. Charge the remote-control

When the red indicator appears and blinks, please charge the remote-control.

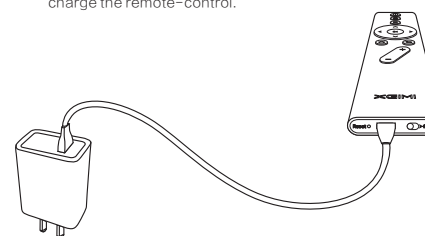

### 4. Introduction of remote-control functions

- Gravity sensor function**  
Slip "fn" key on the bottom of remote-control to the right side, gravity sensor function is turned on. Pairing with games that support gravity sensor and use remote-control horizontally. Slip "fn" key on the bottom of remote-control to the left side, gravity sensor function is turned off. When gravity sensor function is turned on, mouse function cannot be used, and blue indicator light flashes continuously.
- Mouse function**  
Quickly and forcibly shake the remote-control to turn on/off the mouse function.
- Menu key function**  
Short press "menu key (≡)" to open menu function, long press "menu key (≡)" to open shortcut function.
- Power status**  
Red indicator light flashes continuously when remote-control is charging; green indicator light flashes continuously when charging is completed; red indicator light quickly blinks for 4 times when power is low; red indicator light quickly blinks for 10 times when power is very low, remote control has to be charged immediately.
- Stand-by and sleep conditions**  
Under working mode, remote-control will enter sleep condition when it is standing for more than 10 seconds, it can be awaked by pressing any button.
- Reset function**  
If remote-control's system is crashed, press reset button, then release reset button, red indicator light will blink for 3 times, reset is completed.

## 4 Switch Desktop Versions

- Press "up" key of remote control on home page to access shortcut entry, then switchover between standard version and business version.
- System setup > General setup > Desktop Version, switchover between standard version and business version.

## 5 Switch Languages

- System setup > international setting, to choose your language and time zone.

## 6 Application Management

- Application Search**  
Aptoide App market > Press search symbol > enter the application name and download.
- Application update**  
Aptoide > updates, to update your installed application.
- Application move/delete**  
Choose the App you want to change, long press "OK" key to move/uninstall/collect it.

## 7 Projection Setup

### Keystone correction

- System setup > projection setup, Press "gyroscope correction"
- System setup > projection setup, Turn on "auto keystone correction"

Note:

- Please manually adjust the screen from keystone correction, if the effect of auto keystone correction is not perfect.
- This device only supports vertical keystone correction.

Chengdu Xgimi Technology Co., Ltd.

A7-5F, Taoru Software Park, High-Tech Zone, Chengdu, 610041, China  
+86-28-61993556 ext 803 en.xgimi.com service@xgimi.com